



ARUNIMA

An Assisted Living Community

WWW.PROJECTARUNIMA.ORG

ARUNIMA

A project for Adults with Autism

Launching a comprehensive infrastructure cum service project to answer the question

“What After Us?”

one that hangs like a sword over the heads of so many parents of our friends with neurodiversity.



LOCATION

- The site of the project is located at Chalang in Dehradun, in the foothills of tranquil mountains, 10 Km from Mussoorie diversion.
- The size of the site is 2700 sq yards with residential **land-use in the approved masterplan.**
- The site is very close to necessary community facilities like shops, public transport, hospital etc.
- Dehradun railway station- 13.8 km from the site.
- Jolly grant International airport- 33.9 km from the site.
- Police Station : Rajpur Police station – 4.7 km from the site.
- Hospital : Max super speciality hospital, Dehradun - 7.1 km from the site.
- Pacific Mall : - 7.3 km from the site.
- Pacific golf estate - 1.8 km from the site.
- Google coordinates of the site: 94Q3+PFH, Kulhan, Chalang, Uttarakhand 248009

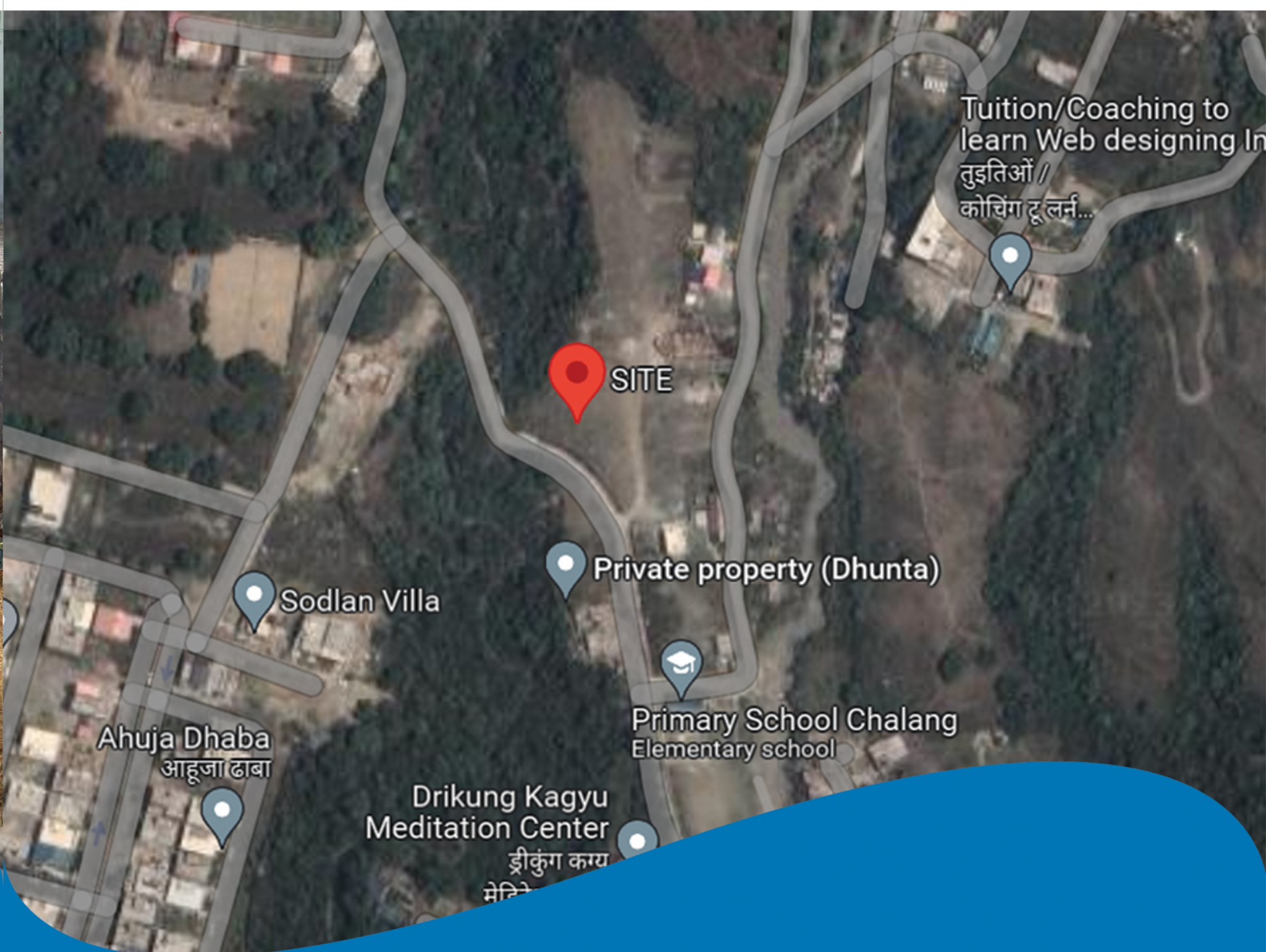

NEARBY PLACES



PANACHE VALLEY

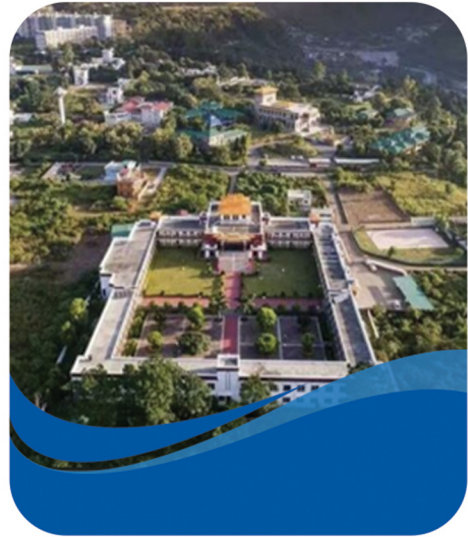

DRIKUNQ KAAYU
INSTITUTE



DRIKUNG KAGYU
MEDITATION CENTER

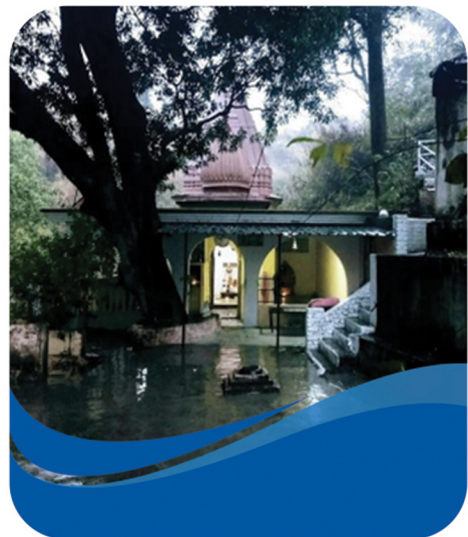

SHIV MANDIR

PROPERTY FEATURES

- The project will provide a home-like environment and life-long care in the serene city of Dehradun, for 32 neurodiverse individuals.
- The infrastructure of the project will have three components:
 - 1. Residence:** The residence will include 8 flats, built to accommodate a total of 32 residents and 16 staff. Each flat will have its own living and dining area as well as kitchenette. The flats will provide a personal bedroom and toilet for each resident.
 - 2. Skilling center:** A work space for activities and jobs that our friends will be engaging in.
 - 3. Common Amenities:** A dining area a commercial kitchen, house-keeping storage, laundry, infirmary and open spaces for interaction, activities, sports and sensory integration.
- Every family will be required to make a permanent arrangement for a payment of a monthly fee for life-long care giving services.
- A one time membership deposit will need to be paid for enrollment in the Assisted Living Center.



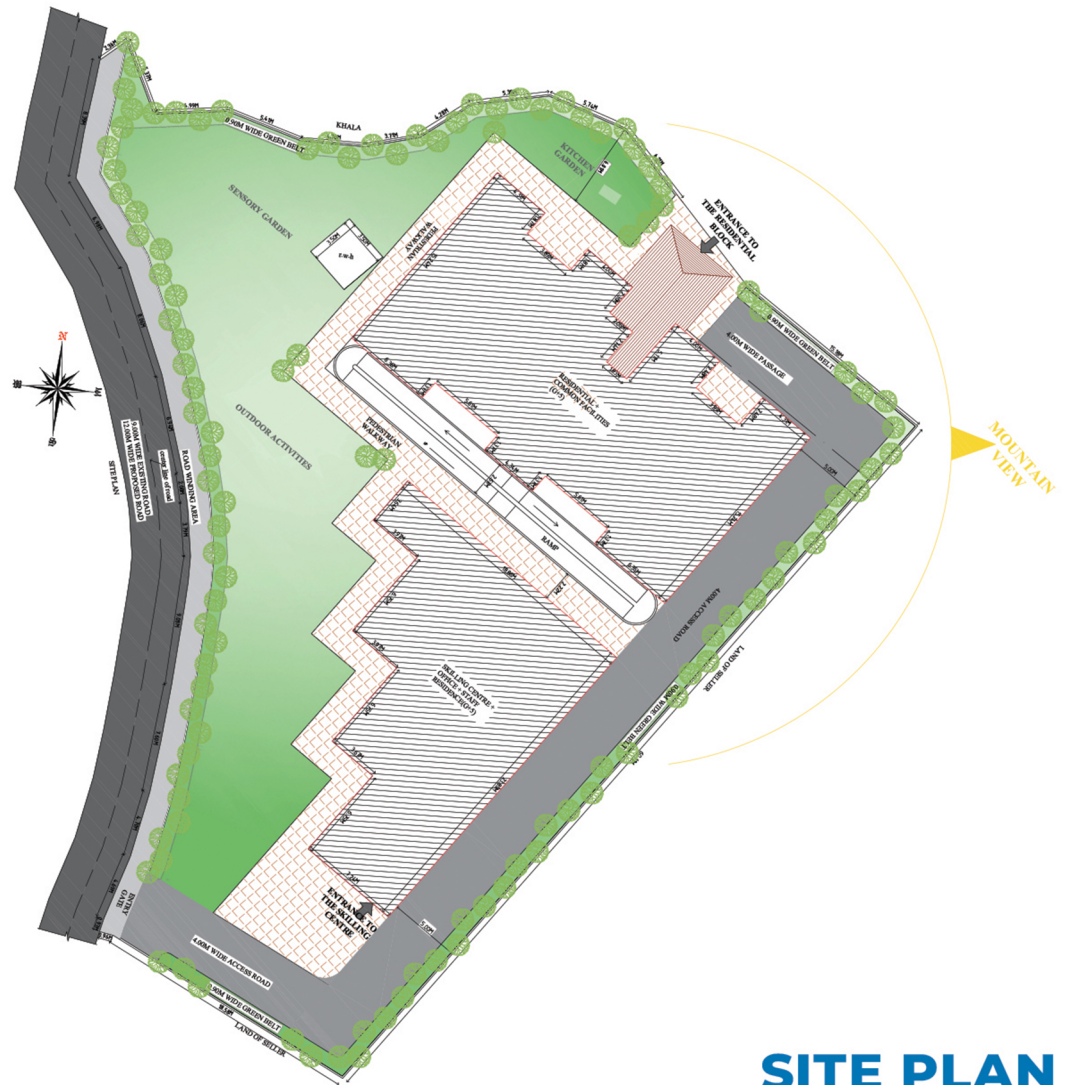

SITE PLAN



TYPICAL RESIDENCE FLOOR PLAN



COMMON DINING LEVEL PLAN



RESIDENCE FLOOR VIEW



SINGLE FLAT VIEW



INDIVIDUAL BEDROOM VIEW



SALIENT FEATURES OF DESIGN

- The design provides a variety of spaces to help residents engage in activities as per their choice.
- With individual rooms that can be personalized, living environments can be adjusted to the desired level of social engagement or privacy.
- Since assisted living will address the needs of residents for their whole lifespan, the building design provides accessibility features and ample space for assistance (if required), in the living area as well as outdoor spaces.
- The specifications of building material, fixtures, furnishings, etc. will address the need to have a safe, user friendly and durable environment that is easy to maintain.

Approved by MDDA

The map of the building is **approved by Mussoorie Dehradun Development Authority** for the purpose of assisted living and follow regulations of FAR, ground coverage, building height, fire safety, barrier free environment etc.

 **+91-8859046829**

 **aparnajacob@projectarunima.org**

 **www.projectarunima.org**

Registered Address
394, Sinaula, Dehradun,
Uttarakhand, India

